



Licensing Act 2003

# Premises Licence Summary

**PLWA0969**

**East Devon District Council** has granted this Premises Licence in accordance with the Licensing Act 2003. The licence authorises the identified premises to accommodate the licensable activities set out in the document and the plan deposited with and approved by the Licensing Authority. Where the sale of alcohol is authorised as a licensable activity the licence identifies the Designated Premises Supervisor.

## Premises Details

### POSTAL ADDRESS OF PREMISES, OR IF NONE, ORDANCE SURVEY MAP REFERENCE OR DESCRIPTION

#### Betsy's Knapp

Corner Bickwell Lane & Station Road / Bulverton Rd, SIDMOUTH, Devon.

### WHERE THE LICENCE IS TIME LIMITED THE DATES

Commences **04/08/23**

expires **12/08/23**

### LICENSABLE ACTIVITIES AUTHORISED BY THE LICENCE

- a performance of live music
- any playing of recorded music
- a performance of dance
- entertainment of a similar description to that falling within a performance of live music, any playing of recorded music or a performance of dance
- provision of late night refreshment
- the supply of alcohol

### THE TIMES THE LICENCE AUTHORISES THE CARRYING OUT OF LICENSABLE ACTIVITIES

Activity (and Area if applicable)	Description	Time From	Time To
E. Performance of live music (Indoors)	Monday to Sunday	9:30am	1:30am
F. Playing of recorded music (Indoors)	Monday to Sunday	9:30am	1:30am
G. Performance of dance (Indoors)	Monday to Sunday	9:30am	1:30am
H. Entertainment of a similar description to that falling within E, F, or G (Indoors)	Monday to Sunday	9:30am	1:30am
I. Late night refreshment (Indoors & Outdoors)	Monday to Sunday	11:00pm	4:00am
J. Supply of alcohol for consumption ON the premises only	Monday to Sunday	11:00am	2:30am



Licensing Act 2003

# Premises Licence Summary

# PLWA0969

## THE OPENING HOURS OF THE PREMISES

Description	Time From	Time To
Monday to Sunday	9:30am	5:00am

## WHERE THE LICENCE AUTHORISES SUPPLIES OF ALCOHOL WHETHER THESE ARE ON AND / OR OFF SUPPLIES

- J. Supply of alcohol for consumption ON the premises only
---

## NAME, (REGISTERED) ADDRESS OF HOLDER OF PREMISES LICENCE

Sidmouth FolkWeek Productions Limited	3 Church Street, Aylesbury, HP20 2QP.
---------------------------------------	---------------------------------------

## REGISTERED NUMBER OF HOLDER, FOR EXAMPLE COMPANY NUMBER, CHARITY NUMBER (WHERE APPLICABLE)

Sidmouth FolkWeek Productions Limited	05610997
---------------------------------------	----------

## NAME OF DESIGNATED PREMISES SUPERVISOR WHERE THE PREMISES LICENCE AUTHORISES THE SUPPLY OF ALCOHOL

Dominic MOSS
--------------

## STATE WHETHER ACCESS TO THE PREMISES BY CHILDREN IS RESTRICTED OR PROHIBITED

Not applicable
----------------

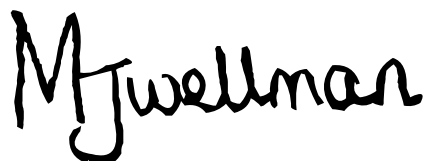

**Melanie Wellman**  
Director of Governance and Licensing





JUDGE DAY LTD  
01225 740743  
Info@JudgeDay.co.uk  
www.JudgeDay.co.uk

**DRAWING STATUS**

FOR INFORMATION

- Catering Structure
- Pedestrian Trackway
- Single Bench
- Toilet
- Fire Point
- STD Access/Egress
- Emergency Exit
- Water Point
- Picket Fence
- Heras Fence
- Licensable Area

**CLIENT**

SIDMOUTH FOLK FESTIVAL

**PROJECT**

SFF 2023

**TITLE**

BULVERTON SITE MAP V2

**DATE**

06/02/23

**SCALE**      **DRAWN BY**

1:500 @ A3

ECL

**DRAWING NO.**

**REV**

SFF23\_BUL0012.A

A

This drawing is protected under copyright and at no time should this drawing be reproduced in whole or in part without the permission of Judge Day Ltd.

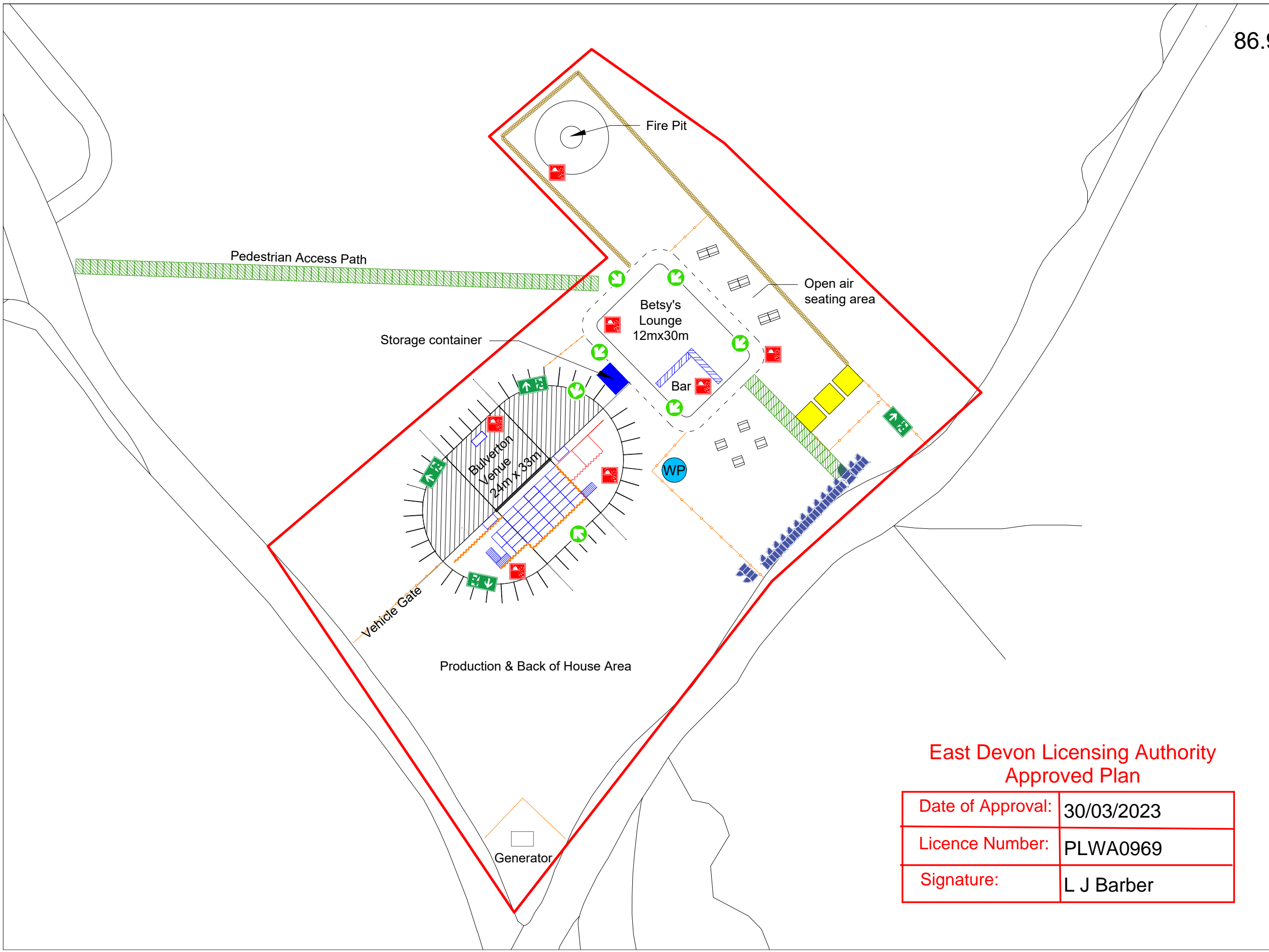

East Devon Licensing Authority  
Approved Plan

Date of Approval:	30/03/2023
Licence Number:	PLWA0969
Signature:	L J Barber

86.9